

Sunset And Vine Mystery Quilt

Clue Six

Cutting:

The Supporting Players: (Dark Only) (Background)

2 ea. 5 1/4" width of fabric strips

Cut these into 12 ea. 5 1/4" squares (Geese)

The Stand-Out: 4 ea. 2 7/8" width of fabric strips

Cut these into 48 ea. 2 7/8" squares (Sky)

Assembly:

1. Finger press or draw one diagonal crease in each of your smaller (Sky) squares. Mark 48.
2. Lay two smaller (Sky) squares right sides together (RST) to the larger square so the smaller squares align with opposite corners of the larger (Goose) square as at right. Be sure diagonal creases line up as shown. Make 12.
3. Stitch 1/4" on both sides of those creases. Cut on the diagonal. Now you have two odd looking sections (shown). Press to the Sky Triangles. Make 48 odd looking units.
4. On each section, lay another Sky square RST in the corner of each Goose as shown.
5. Stitch on both sides of marked diagonal. Cut on the diagonal.
6. Press to the Sky triangles and you have four Flying Geese units. Trim if necessary. Make 48 Flying Geese Units.

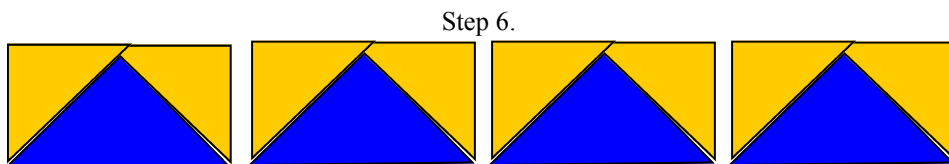
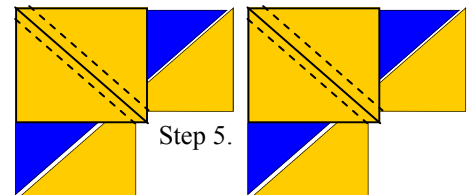
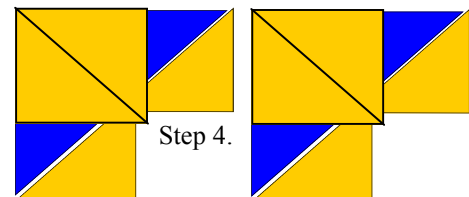
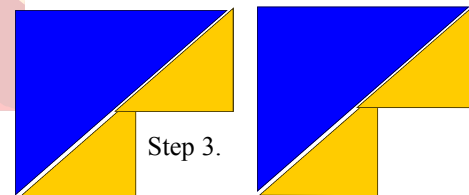
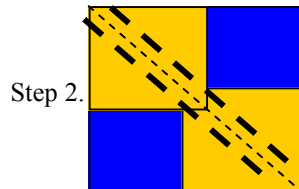
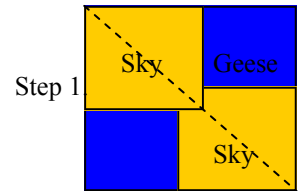

**Check back at LynBrown.Com On August 14, 2012
For Clue 7 of the Sunset and Vine Mystery!**

